

FLOOR
3

UWMC Floor Maps for Patients and Visitors

October 2012

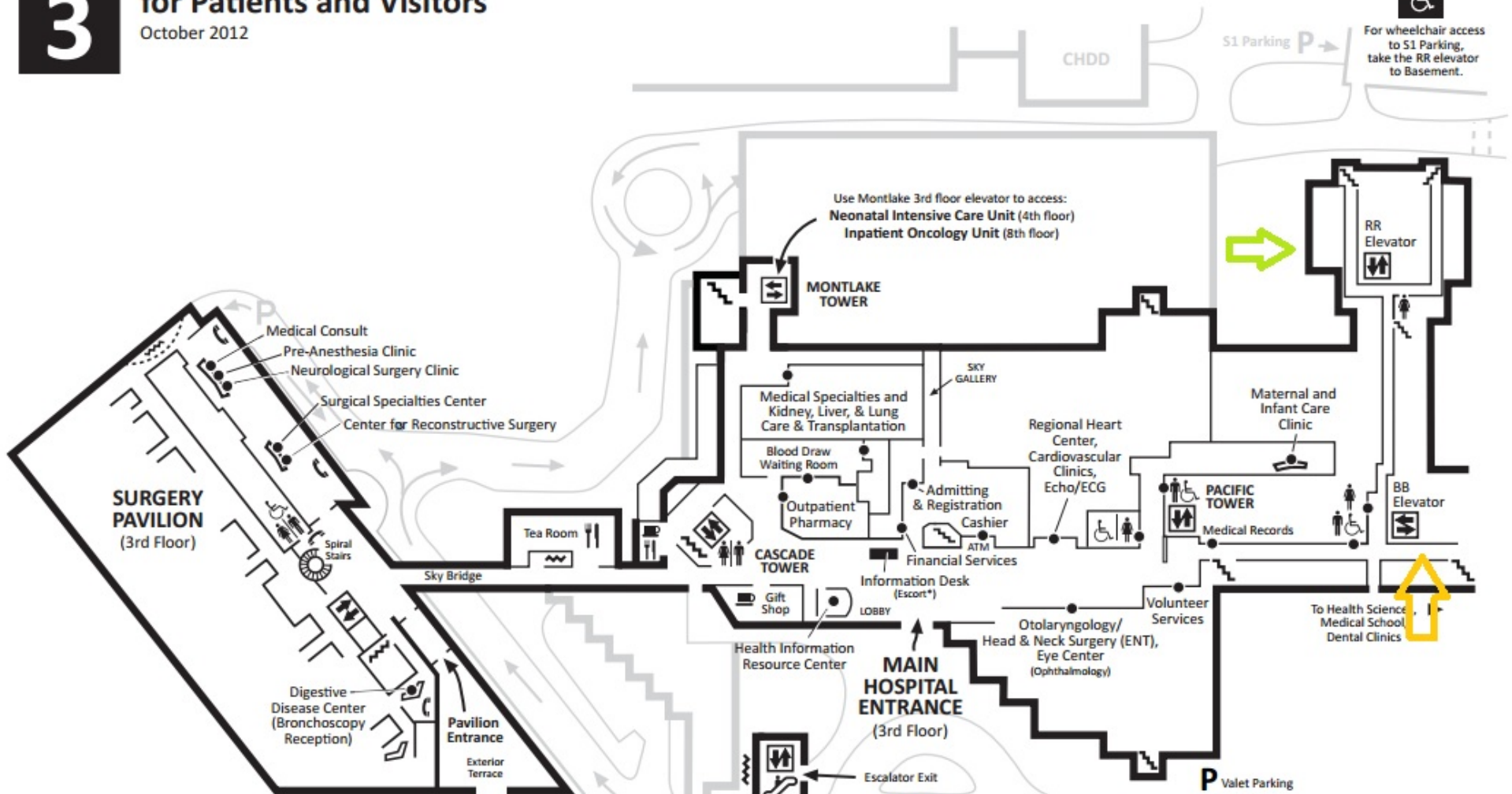

From BB Elevators:

On the BB elevators, go to the BASEMENT (**B**). Note that only 2 of the 4 elevators will go directly to the basement. If inaccessible, please get off at FLOOR 1 and then press down again to get to basement.



Upon exiting elevators, turn **LEFT** (as directed in the Diagnostic Imaging Sciences Center/MRI sign).



Continue down the hall. Welcome to the **Integrated Brain Imaging Center**.

From RR Elevators:

Please press down and go to the BASEMENT (B).



Upon exiting elevators, turn LEFT.



Turn RIGHT at the junction.



Continue down the hall. Welcome to the **Integrated Brain Imaging Center**.